

REV.	DESCRIPTION	DRAWN	CHECKED	APPROVED
A	NEW RELEASE	ZQJ 11/18/2014	~	ZQJ 11/18/2014
B	ADD P/N CODE	CJJ 11/18/2014	~	

SPECIFICATIONS
Current Rating: 1Amps
Insulator Resistance: 1000Megaohms min.
Dielectric Withstanding: AC 500V
Operating Temperature: -40 ° ~ +105 ° c
Contact Material: Phosphor bronze
Insulator Material: NY-6T
Finish: Gold flash
UNSPECIFIED TOLERANCE : ± 0.20

Dimensions List

Contacts Per Row	A	B	Contacts Per Row	A	B
2*02	2.54	1.27	2*22	27.94	26.67
2*03	3.81	2.54	2*23	29.21	27.94
2*04	5.08	3.81	2*24	30.48	29.21
2*05	6.75	5.08	2*25	31.75	30.48
2*06	7.62	6.35	2*26	33.02	31.75
2*07	8.89	7.62	2*27	34.29	33.02
2*08	10.16	8.89	2*28	35.56	34.29
2*09	11.43	10.16	2*29	36.83	35.56
2*10	12.70	11.43	2*30	38.70	36.83
2*11	13.97	12.70	2*31	39.37	38.10
2*12	15.24	13.97	2*32	40.64	39.37
2*13	16.51	15.24	2*33	41.91	40.64
2*14	17.78	16.51	2*34	43.18	41.91
2*15	19.05	17.78	2*35	44.45	43.18
2*16	20.32	19.05	2*36	45.72	44.45
2*17	21.59	20.32	2*37	46.99	45.72
2*18	22.86	21.59	2*38	46.99	54.61
2*19	24.13	22.66	2*39	49.53	48.26
2*20	25.40	24.13	2*40	50.80	49.53
2*21	26.67	25.40			

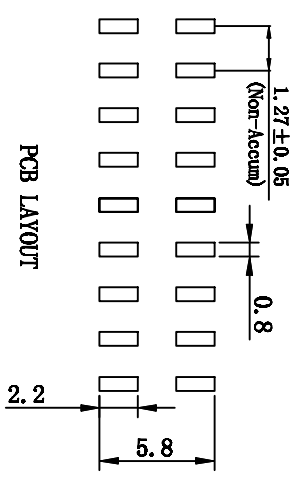
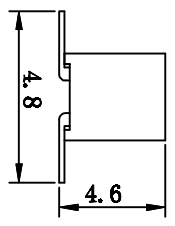
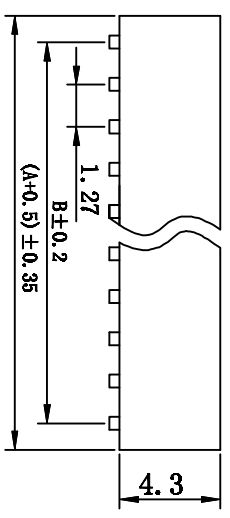
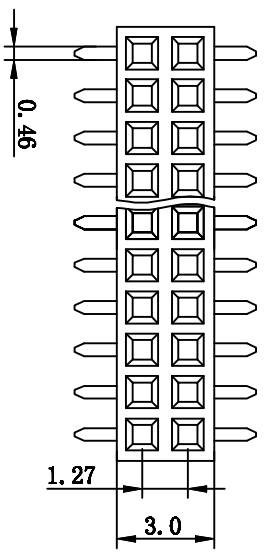

ITEM	PART NAME	PART NO.	MATERIALS	FINISHED
2	CONTACT		COPPER ALLOY	GOLD OR TIN PLATED
1	HOUSING		THERMOPLASTIC	UL 94 V-0

GENERAL TOLERANCE	ANGLE TOLERANCE
X, ±0.60	X, ±5°
.X, ±0.38	.X, ±3°
.XX, ±0.25	.XX, ±2°

PROJECTION	TITLE
UNITS: mm	1.27MM 2*40Pin Female Header
SHEET SIZE: A4	SMT H=4.3MM
SERIES: LL1018-5A	

DRAWING TYPE	CUSTOMER	SCALE	DRAWING NO.
SCALE	1:1	SHEET	1 OF 1

DRAWING TYPE	CUSTOMER
SCALE	1:1

LANLING
慈溪蓝翎电子有限公司
CIXI LANLING ELECTRONICS CO., LTD.