

REV	DESCRIPTION	DRAWN	CHECKED	APPROVED
A	NEW RELEASE	ZQJ 11/18/2015	~	ZQJ 11/18/2015
B	ADD P/N CODE	CJJ 11/18/2015	~	CJJ 11/18/2015

SF12

直式母插头 (镀铬)
straight female plug (Chrome plated)

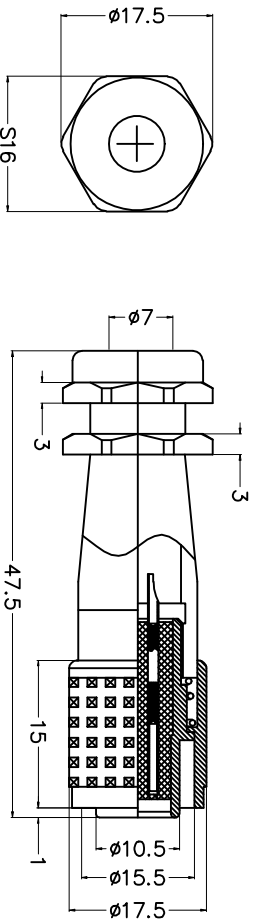

直式公插头 (镀铬)
straight male plug (Chrome plated)

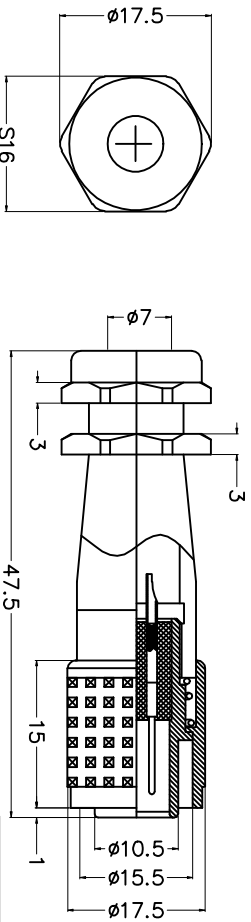

数量	公差	表面粗糙度	镀层厚度	材料	长度	直径	接触直径	接触长度
2	±0.15	0.4	0.15	磷铜	47.5	17.5	7	3
3	±0.15	0.4	0.15	磷铜	47.5	17.5	7	3
4	±0.10	0.4	0.10	磷铜	47.5	17.5	7	3
5	±0.10	0.4	0.10	磷铜	47.5	17.5	7	3
6	±0.10	0.4	0.10	磷铜	47.5	17.5	7	3
7	±0.10	0.4	0.10	磷铜	47.5	17.5	7	3
9	±0.17	0.4	0.17	磷铜	47.5	17.5	7	3

GENERAL TOLERANCE		ANGLE TOLERANCE		PROJECTION		TITLE	
X	±0.60	X	±5°	UNITS	mm	SHEET	SF12 直式公插头 直式母插头
.X	±0.38	.X	±3°	SHEET SIZE	A4	SERIES	SF12 Straight male+female plug
.XX	±0.25	.XX	±2°				

ITEM	PART NAME	SCALE	DRAWING NO.	CUSTOMER	SHEET	1 OF 1
1	HOUSING	1:1				
2	CONTACT					

慈溪蓝翎电子有限公司
CIXI LANLING ELECTRONICS CO., LTD.